

MICROFILMED

N/F ADAMS

N67°36'E 170.0'
10' ESM'T.

887.8'

891.0'

LOT 45

LOT 46

LOT 47

N18°49'W 160.3'
5' ESM'T.

5' ESM'T.

NO6°21'E 204.0'

MAG.

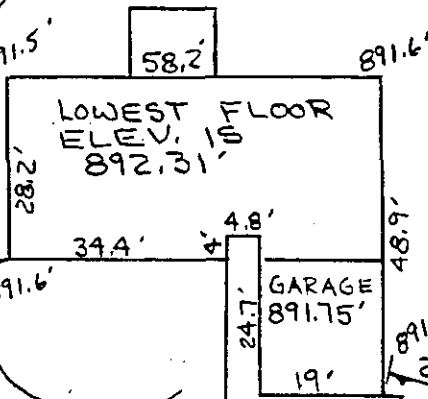

FILED
GREENVILLE CO. S.C.
JAN 17 11 03 AM '84
DONNIE S. JARRERSLEY
R.M.C. 40'

894.5' 25.5' N67°36'E N86°06'E 60.0' 896.4'

ASHMORE BRIDGE RD. 469' TO INT.
AMBERWOOD LN. 50' R/W

JAN 17 1984

10-G-82

22174 ✓

Greenville County
South Carolina

Date: January 3, 1984
Scale: 1" = 30'

Plat and building location of Lot 46, Adams Mill Estates, belonging to Westminster Company, Inc., and recorded in plat book _____, page _____, Office of R.M.C. I hereby certify that the measurements as shown on this plat are correct and there are no encroachments or projections other than shown, and to the best of my knowledge this lot is not subject to flooding.

Heaner engineering co., Inc.
greenwood, s. c.

Registered Land Surveyor, #6571

